



IMPORTANT: Read the Operator's manual thoroughly, and follow safe operating practices.



WARNING: When working with the product, wear the required personal safety equipment.

1A

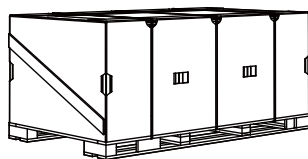

1B

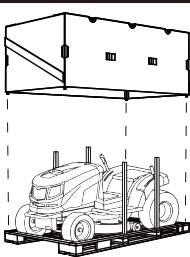

1. OPENING THE PACKAGING

The machine is shipped partially dismantled and packaged in a crate to protect it during transport. The packaged machine will appear as in Fig 1A.

- Remove all shrink wrap and cut the three plastic straps that surround the package.
- Lift off the corrugated exterior cover assembly and discard the four wooden support posts. (Fig 1B)

NOTE WEAR HEAVY GLOVES.

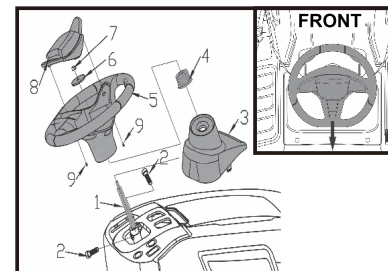

2. FITTING THE STEERING WHEEL

- Fit the shaft (1) onto the couplings and tightening the screw M8x25 (2) (Use the open end wrench 8-10 in accessories tools).
- Fit the steering shaft cover (3).
- Inset the splined hub (4) to shaft (1), mounting steering wheel (5), spacer (6) and tightening nut M8 (7) (Use the open end wrench 13-15 in accessories tools).
- Inset the steering wheel cover (8) into steering wheel and tighten two screws ST4.8x16 (9) (Use the Philips screwdriver in accessories tools).

NOTE PAY ATTENTION TO THE ORIENTATION OF THE PARTS.

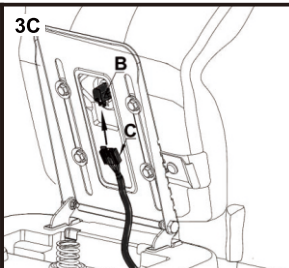
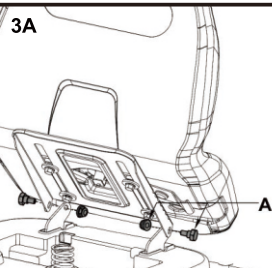

3. MOUNT THE SEAT AND CONNECT THE OPERATOR PRESENCE SWITCH

- Unfasten the two M8 nuts and bolts (A) from the Seat Brackets located on top of the mower. (Use the 13-15 open-end wrench from the accessories tools kit)
- Mount the Seat onto the Seat Brackets using the released two M8 nuts and bolts (A) as illustrated.
- Connect the Wire Harness (B) to the Operator Presence Switch (C) located under the seat as illustrated.

NOTE BE SURE THAT THE CONNECTION IS COMPLETE.

IMPORTANT! THE TOTAL WEIGHT (TRAILER AND LOAD, INCLUDING THE OPERATOR) MUST NOT EXCEED 136 KG (300 LBS.). SEE COMPLETE NOTES UNDER REGULATIONS FOR TOWING IN THE OPERATOR'S MANUAL.

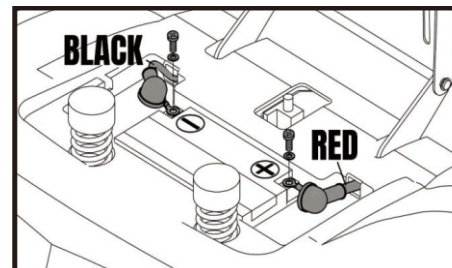

4. CONNECTING THE BATTERY

- Fit the battery in its housing.
- Connect the battery connectors to the machine connection leads and tighten the two screws. Then cover the protective cap for the two wires in place. (Use the open-end wrench 8-10 and cross screwdriver in accessories tools)
- Secure the battery with the small rubber strap.

NOTE POSITION THE BATTERY WITH THE POLARITIES (+) AND (-) AS INDICATED.

HAZARD! SULFURIC ACID IS POISONOUS. THE ELECTROLYTIC FLUID IS A SOLUTION OF SULFURIC ACID.

HAZARD! SULFURIC ACID IS CORROSIVE. SULFURIC ACID CAN CAUSE BLINDNESS OR SEVERE BURNS.

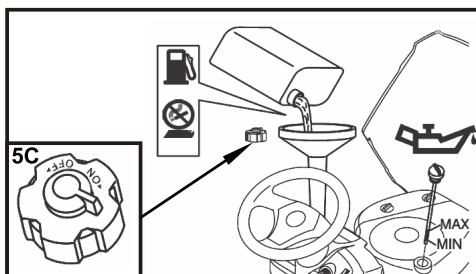

5. CHECKING THE FUEL AND OIL

- Locate the machine on level ground.
 - With the engine off, check the oil level.
 - Use oil grade according to the instructions in the engine manual.
 - Fill between the MIN and MAX marks on the dipstick.
- FUEL:**
- Refuel using a funnel, but do not completely fill the tank.
 - The tank's capacity is approximately 7.5 liters.
 - Before operating the mower, open the Fuel Shut Off Valve on the fuel cap to ON (Fig 5C).

IMPORTANT! THE MACHINE IS SHIPPED WITHOUT LUBRICATING OIL IN THE ENGINE.

CAUTION! IRREPARABLE DAMAGE TO THE ENGINE: FILL UP WITH OIL BEFORE STARTING THE ENGINE.

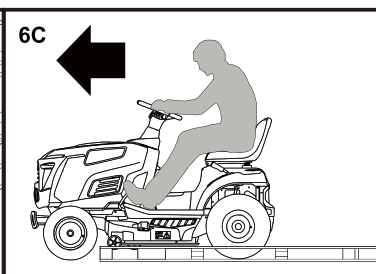
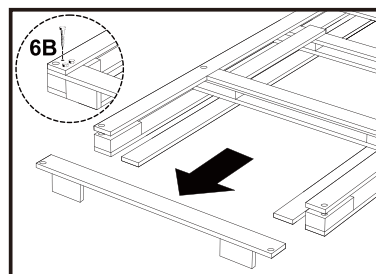

6. DRIVE RIDING MOWER OFF THE PALLET

- After installing the steering wheel and seat, increase the tractor's cutting deck height to its maximum level.
- Remove the six bolts near the front of riding mower's pallet and remove the wooden cross plank from the base pallet. (Fig 6B).
- Follow the instructions in section CONTROLS AND STARTUP and OPERATIONS / STARTING to carefully drive the Tractor Mower forward off the wooden base platform. (Fig 6C)

IMPORTANT! IMPORTANT ONLY THE PRELIMINARY MACHINE CONTROL FUNCTIONS ARE EXPLAINED IN THIS QUICK START GUIDE TO ENABLE THE CONTROLS REFER TO THE APPROPRIATE CHAPTERS IN THE OPERATOR'S MANUAL.