

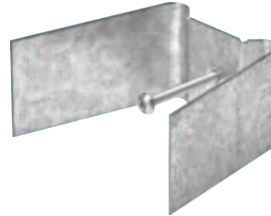

820D-RP



CILRW



CI1004-P



CI1104-P



SBEX-V2-RP



CIXCUBE

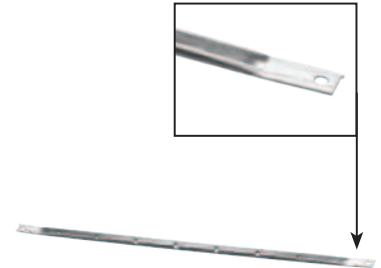

1060CP



Cat. No.	Features	Packaging
820D-RP	Device box supports. Maximum wall thickness 1 in.	Bag of 2 units
820DB6		Box of 6 units
820-D-CP		Bag of 6 units
820DP30		Box of 30 units
CI820-DX	Device box supports. Maximum wall thickness 1/2 in. Also for use on double 1/2 in. drywall.	
CILRW	For use with any 1104 box with ears in rework applications. Complete with 8-32 x 1-1/2 in. screw.	
CILA CLAMP	Replacement cable clamp for nonmetallic and armoured cable. Complete with screws.	
CI1004P	Steel partition for use with 2 in., 2-1/2 in. and 3 in. deep device boxes.	
CI1104-P	Steel partition for use with 2-1/2 in. deep gangable device boxes. For new work applications.	
CI2104P	Steel partition for use with 2 in. and 2-1/2 in. deep device boxes.	
C.E.C. 2012 Edition, rule 12-3030. A partition must be used when conductors, in a multi-gang box, are connected to different sources of voltage.		
SBEX-V2-RP	2 in. x 3 in. switch box extender complete with mounting screws - Maximum adjustable depth is 7/8 in.	Bag of 1 unit
CIX-CUBE	Add 5.5 in ³ capacity to any 2-1/2 in. deep gangable device box. Provisions for external nailing.	
GS-1-IB *	8-32 x 5/16 in. combination large head ground screws.	
1060CP	16 long support brackets, grooved for box ears.	

*Not CSA certified