

TOPMOUNT INSTALLATION INSTRUCTIONS FOR GRANITE SINKS

CAUTION: Parts of the sink may be sharp. Please use gloves to handle the sink. Always use proper protective equipment.

Step 1 PREPARE THE COUNTER TOP

Check clearances above and below the counter. Make sure there are no obstructions such as cupboard partitions, braces or pipes to interfere with the installation. Thickness of the counter top must not be more than 1 1/2" (38mm) thick at sink rim. Position the template flat on the countertop in the desired position. Draw a line around the perimeter of the template (1A.). Remove the template. Drill a pilot hole on the inside of the drawn line (large enough for the jig saw blade to fit) (1B). With the Jig saw cut on the inside of the line (1C).

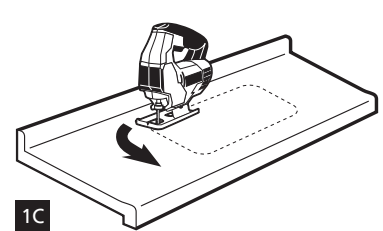
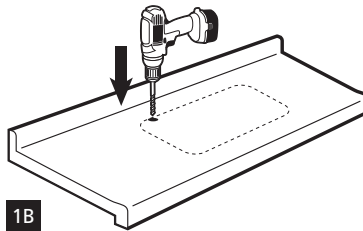
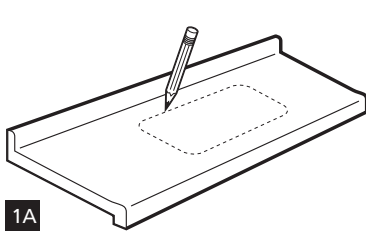

Step 2 PREPARE THE SINK

Remove the sink from packaging. Place the sink face down on a flat disposable surface. Use the provided diamond hole saw to drill the faucet hole in the desired location (already started on the bottom of the sink). Never attempt to drill the top side of the sinks. Only a little force is required to drill the hole, let the drill do the work. When the hole saw is through the sink, remove and discard the center of the hole. Please note the diamond hole saw is sharp and will cut into the surface below the sink. Always use a piece of scrap below the face of the sink when performing this task. Always use the proper protective equipment including safety glasses and a dust mask.

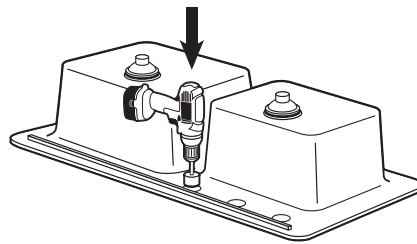

Step 3 INSTALL THE FAUCET AND STRAINER(S)

Follow the recommended instructions that are included with the strainer(s) and faucet. In addition to the faucet instructions, please install the included red faucet spacer (133.0533.532) on the base of the sink as shown in this figure (after drilling is complete). The flat side of the spacer aligns with granite rail.

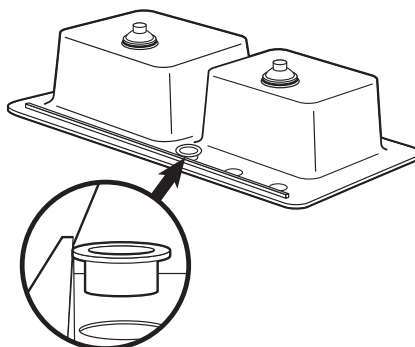

Step 4 PREPARE THE COUNTER TOP

Add a continuous 1/4" bead of silicone around the perimeter of the cutout. Install the sink before the silicone dries.

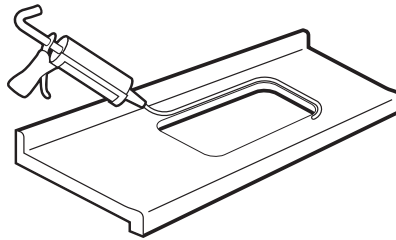

Step 5 INSTALL THE SINK

With the pre-attached fasteners it's very important to align the sink left to right in the center of the cutout hole before you push down on the sink. The clips on the sink bite into the vertical surface on the cutout. When the sink is fully pushed down the sink cannot be easily removed.

Once the sink is fully seated, wipe up any residual silicone. Connect faucet and strainers to the existing plumbing. Fill the bowls with water and check for plumbing leaks in the cabinet.

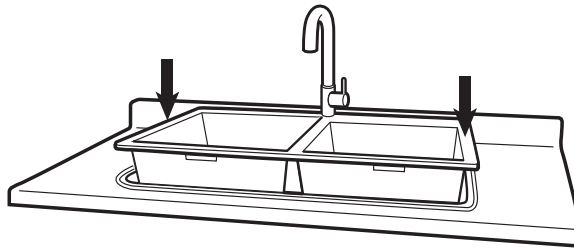

Sink removal (should not be required).

In order to remove the sink you will need to purchase several putty knives (one for each fastener). Insert the putty knives between the cutout and the clips (all at the same time). Push the blade of the putty knife as far as it will go. (Friction will hold them in place). This will release the prongs from the cutout and allow the sink to be removed.

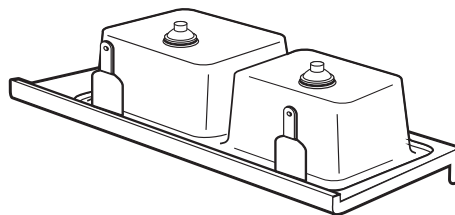

Kindred Customer Service Inquiries:

CANADA
Franke Kindred Canada
1000 Franke Kindred Road
Midland, Ontario Canada L4R 4K9
Telephone: 1-866-687-7465
Fax: 1-800-361-8408
Email: info@kindred-sinkware.com

Monday to Thursday 8:00am to 5:00pm
Friday 8:00am to 3:30pm
(Eastern Standard Time)

USA
Kindred-USA
800 Aviation Parkway
Smyrna, TN 37167
Telephone: 1-800-626-5771
Email: ks-customerservice.us@franke.com

Monday to Friday 8:00am to 5:00pm
(Central Standard Time)