

BENCHMARKTM MC

MITER SAW STAND

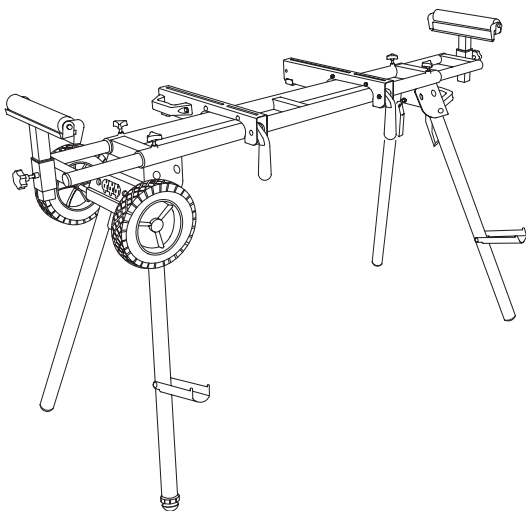

2 Year Limited Warranty on tool

**READ ALL INSTRUCTIONS BEFORE FIRST USE.
KEEP THIS MANUAL FOR FUTURE REFERENCE.
KEEP AWAY FROM CHILDREN.**



**WEAR CSA APPROVED
EYE PROTECTION**



**WEAR EAR
PROTECTION**



**WEAR A
FACE MASK**

PRODUCT SPECIFICATIONS

MITER SAW STAND		
Height	35.4" - 39.3" (90 cm - 100 cm)	
Extended Length	46.5" - 78.7" (118.5 cm - 200 cm)	
Maximum Load Capacity	330 lbs (150 kg)	
Outlet	Input Voltage	125V AC
	Input Ampere	15 Amps
Net Weight	37.5 lbs (17 kg)	
Gross Weight	42 lbs (19 kg)	



SAVE THESE INSTRUCTIONS

You will need this manual for safety instructions, operating procedures, and warranty. Put it and the original sales invoice in a safe, dry place for future reference.

TABLE OF CONTENTS

Product Specifications	1
Table of Contents	2
Safety Rules	3
Assembly	7
Unpacking	7
Tools Needed	8
Assemble Axle Plate/Socket Case and Wheels	8
Assemble Handle	9
Unfold The Work Legs	10
Assemble Roller Bar/Extension Bar Knobs	10
Pigtail Cord	11
Mounting the Miter Saw	11
Operation	13
Roller Bars/Extension Bars Adjustment	13
Material Supports	13
Leveling	13
Transportation	15
Maintenance	16
General Maintenance	16
Parts Illustration & List	17
Warranty	20

SAFETY RULES

WARNING

For your own safety, read all of the rules and precautions before operating tool.

WARNING

Always follow proper operating procedures as defined in this manual even if you are familiar with use of this miter saw stand or any tool used with this stand. Remember that being careless for even a fraction of a second can result in severe personal injury.

You must be familiar with the use of any tool or accessory used with this miter saw stand. The supplier cannot be held responsible for any accident, injury or damage incurred while using this stand with any tool.

WARNING

Some dust created by operation of power tool contains chemicals known to the State of California to cause cancer, birth defects or other reproductive harm. To reduce your exposure to these chemicals, work in a well ventilated area and work with approved safety equipment.

Always wear OSHA/NIOSH approved, properly fitting face mask or respirator when using such tools.

CAUTION

Do not modify or use this stand for any application other than that for which it was designed.

ELECTRICAL SAFETY

- Power tool plugs must match the outlet. Never modify the plug in any way. Do not use any adapter plugs with grounded power tools. Unmodified plugs and matching outlets will reduce the risk of electric shock.
- Avoid body contact with grounded surfaces, such as pipes, radiators, ranges, and refrigerators. There is an increased risk of electric shock if your body is grounded.
- Do not expose power tools to rain or wet conditions. Water entering a power tool will increase the risk of electric shock.
- Do not abuse the cord. Never use the cord for carrying, pulling, or unplugging the power tool. Keep the cord away from heat, oil, sharp edges, or moving parts. Damaged or entangled cords increase the risk of electric shock.
- When operating a power tool outdoors, use an extension cord suitable for outdoor use. Use of a cord suitable for outdoor use reduces the risk of electric shock. If operating a power tool in a damp location is unavoidable, use a ground fault circuit interrupter (GFCI) protected supply. Use of a GFCI reduces the risk of electric shock.

SAFETY FOR WORK STAND

- Do not attempt to assemble or operate your miter saw stand until you have read the safety instructions in this section.
- Only use your miter saw stand on a hard, dry and flat surface.
- Keep your work area clean and well lit. Cluttered or dark areas invite accidents.
- Do not overreach. Keep proper footing and balance at all times.
- Do not load the miter saw stand with more than 330 lbs (150 kg).
- Store properly. Do not store the miter saw stand outdoors or in a damp location.
- Do not stand or climb on miter saw stand. It could tip over, causing serious injury.
- Do not permit children to use the miter saw stand unsupervised. It is not a toy.
- Be sure all locking pins are in the set-up position holes before using your miter saw and miter saw miter saw stand.
- Take care when moving the stand, especially when a miter saw is mounted.
- Dress properly. Do not wear loose clothing or jewelry. Keep your hair, clothing and gloves away from moving parts. Loose clothes, jewelry or long hair can be caught in moving parts. Always wear non-slip footwear. Tie back long hair. Roll long sleeves above the elbow.
- Always firmly attach the miter saw used with this stand. Do not attempt to use the miter saw on the miter saw stand until the miter saw is fastened firmly.
- Be aware of tipping. When a large piece is cut from one end of a job, the remaining piece may be heavy enough to tip the miter saw stand. Always ensure the workpiece is well supported.
- Always keep all guards in place. Be sure all power tool guards are in good working order and are in proper adjustment and alignment.
- Always keep your hands away from the cutting area.

 **CAUTION**

Think safety! Safety is a combination of operator common sense and alertness at all times when tool is being used.





 **WARNING**







Do not attempt to operate tool until it is completely assembled according to the instructions.

SAVE ALL WARNINGS AND INSTRUCTIONS FOR FUTURE REFERENCE

SAFETY SYMBOLS

The following signal words and meanings are intended to explain the levels of risk associated with this product.

SYMBOL	MEANING
	Failure to obey a DANGER safety alert WILL result in serious personal injury or death to you or to others. Always obey all messages following this symbol to reduce the risk of serious personal injury or death.
	Failure to obey a WARNING safety alert MAY result in serious personal injury or death to you or to others. Always obey all messages following this symbol to reduce the risk of potential serious personal injury or death.
	Failure to obey a CAUTION safety alert MAY result in personal injury or property damage to you or to others. Always obey all messages following this symbol to reduce the risk of personal injury or property damage.
	Failure to obey a NOTICE MAY result in property damage to you or to others. Always obey all messages following this symbol to reduce the risk of property damage.

SYMBOL	NAME	MEANING
V	Volts	Voltage
A	Amperes	Current
Hz	Hertz	Frequency (cycles per second)
W	Watts	Power
min	Minutes	Time
n_0	No Load Speed	Rotational speed, at no load.
	Class II Tool	Double-insulated construction.
.../min	Per Minute	Revolutions, strokes, surface speed, orbits etc., per minute.
	SAFETY ALERT	Indicates a precaution, a warning, or a danger.
	WARNING! Rain or wet conditions.	Do not expose the unit to rain or wet conditions. Keep dry.
	Read operator's manual	To reduce the risk of injury user must read and understand operator's manual before using this product.
	Eye Protection	Always wear safety goggles or safety glasses with side shields, and as necessary a full face shield as well as full ear protection when operating this product.
	Pinch Point	To reduce the risk of injury or damage, avoid contact with any pinch point.
~ or AC	Alternating current	Type of current
— — —	Direct current	Type or a characteristic of current

ASSEMBLY

UNPACKING

Refer to Figure 1

Check for shipping damage. Check immediately whether all parts and accessories are included.

If any parts are damaged or missing, please call 1-833-818-4111 for assistance.

ITEM	DESCRIPTION	QTY
A	Miter Saw Stand	1
B	Quick Release Mounting Brackets	2
C	Roller Bars	2
D	Large Locking Knobs (roller bars)	2
E	Small Locking Knobs (extension bar)	4
F	Wheels	2
G	Retaining Rings (wheels)	2
H	Handle	1
I	Bolt (handle)	2
J	Flat Washer (handle)	2
K	Lock Washer (handle)	2
L	Nut (handle)	2
M	Axle Plate/Socket Case Assembly with hardware	1
N	Pig Tail Cord	1
O	Miter Saw Mounting Hardware (mounting bolt, washer, lock washers and nut)	4

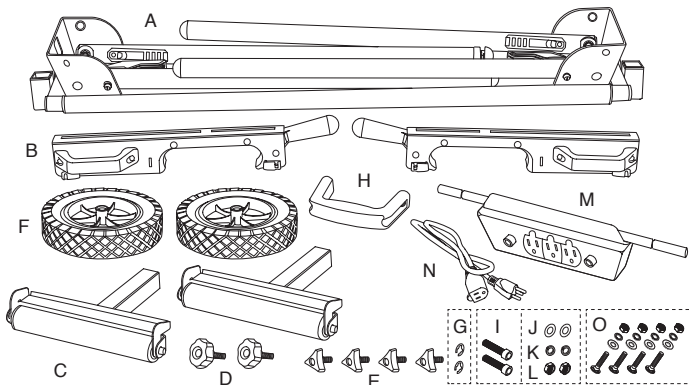

Figure 1

⚠️WARNING

Do not use the miter saw stand until it is completely assembled and you have read and understood this entire operating manual and the operating manual of the tool being used with this miter saw stand.

⚠️WARNING

Do not use the miter saw stand for scaffolding or as a ladder. Make sure to securely tighten all fasteners before using. Maximum capacity is 330 lbs (150 kg). Power tools on the miter saw stand should not exceed a combined overall height of 60" (152.4 cm) from the floor.

TOOLS NEEDED

The following tools (not included) are needed to assemble the miter saw stand:

1. Adjustable pliers
2. #6 Hex wrench
3. #13 Open end wrenches

ASSEMBLE AXLE PLATE/SOCKET CASE AND WHEELS**Refer to Figure 2**

- Remove nuts, washers and lockwashers from axle plate/socket case assembly.
- Place the axle plate/socket case assembly onto the miter saw stand as shown and secure in place with hardware removed earlier.

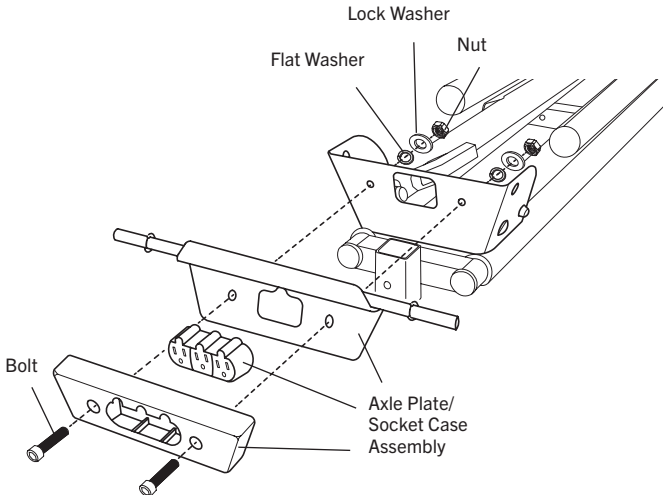
**Figure 2****Refer to Figure 3**

- Slide the wheel onto the axle and secure in place with the retaining ring. Repeat with other wheel.

NOTE: Raised hub goes to the inside.

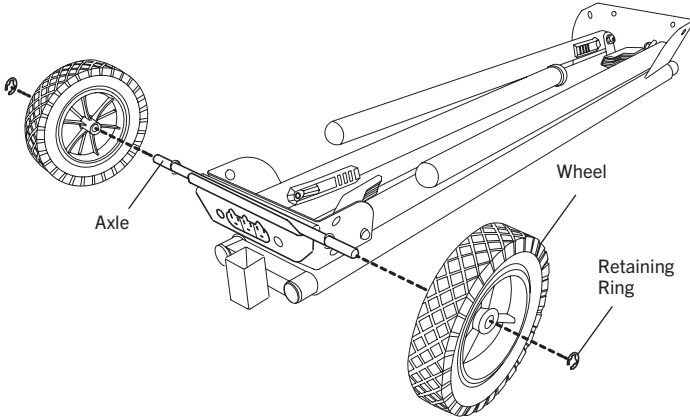

Figure 3

ASSEMBLE HANDLE

Refer to Figure 4

- Secure handle to frame with hardware supplied.

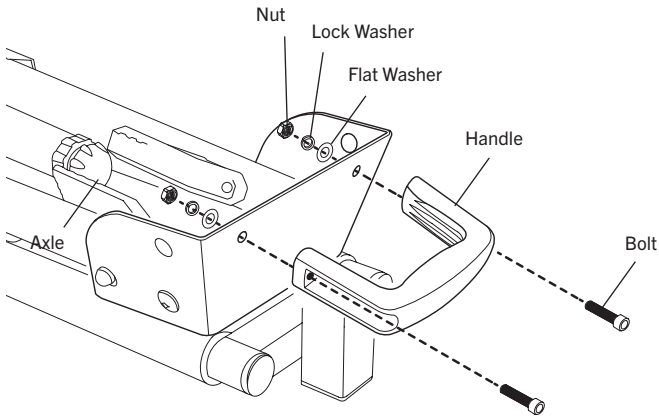

Figure 4

UNFOLD THE WORK LEGS

Refer to Figure 5

- Place the miter saw stand on a flat surface with the folded legs facing up.
- Depress the quick release leg lock lever and rotate the leg until it clicks and locks into the open position. Repeat for each leg.
- The stand should be stable and should not rock. One leg is adjustable, if adjustment is needed, turn the adjustment nut in or out to the required position.

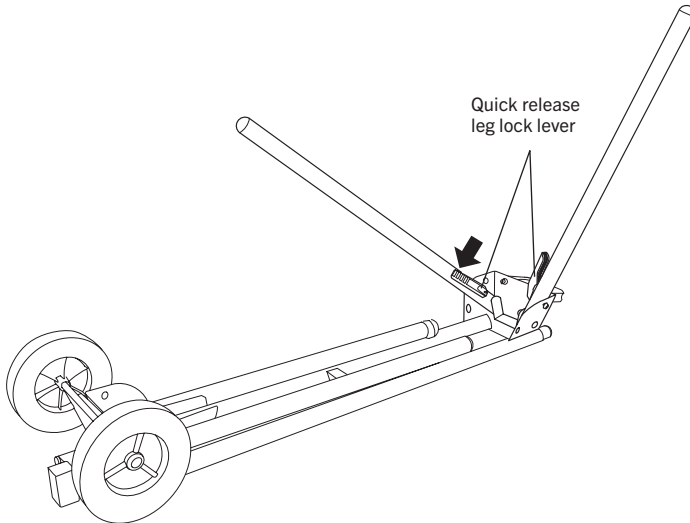

Figure 5

- Place the miter saw stand in the upright position on a flat surface.

ASSEMBLE ROLLER BAR/ EXTENSION BAR LOCKING KNOBS

Refer to Figure 6

- Place the roller arms into the roller bar supports, slide up and down to desired location and secure in place with large locking knobs.
- Assemble the small locking knobs to the frame as shown.

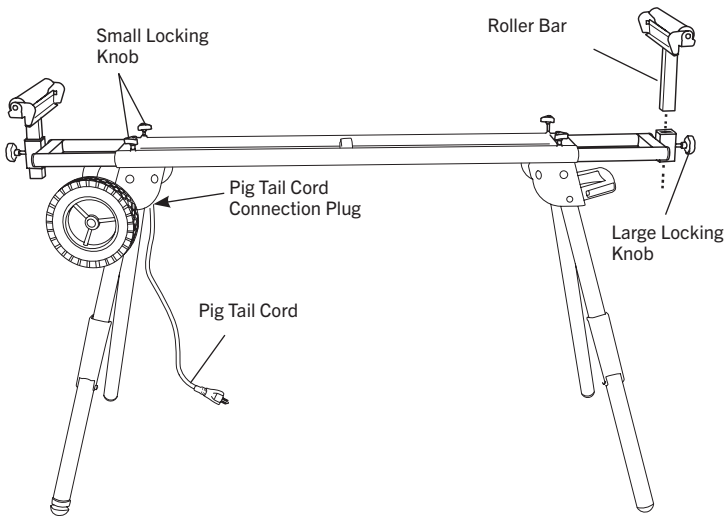

Figure 6

PIGTAIL CORD

Refer to Figure 6

⚠️WARNING

Plugs must match the outlet. Never modify the plug in any way.

The miter saw stand is equipped with three outlets. The mounted miter saw can be plugged in along with two other power tools.

To use the outlets:

- Plug the pigtail cord into the connection plug located under the frame.
- Plug the other end of the pigtail cord into an appropriate outlet.

MOUNTING THE MITER SAW

Refer to Figure 7-8

⚠️WARNING

Risk of accidental starting and serious personal injury. Unplug the miter saw before attaching it to the miter saw stand.

⚠️WARNING

Risk of serious personal injury. Always make sure the miter saw is fully supported and securely attached to a level work surface. Make sure the miter saw stand is located on a flat surface.

⚠ WARNING

Do not mount a table saw on this miter saw stand. Aggressive feeding of sheet materials into a table saw could cause the stand to tip over.

NOTE: This miter saw stand is to be used with miter saws with four mounting holes in a rectangular pattern.

- Mount the miter saw to the quick-release mounting brackets using the supplied hardware (mounting bolt, washer, lock washers and nut) as shown.

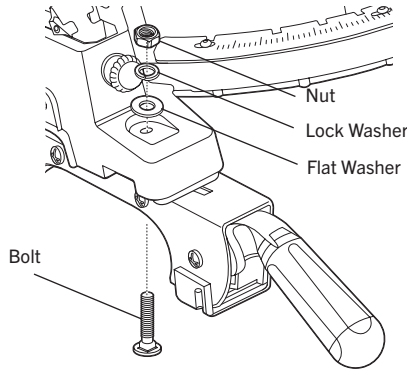

Figure 7

The quick release mounting brackets hook onto the miter saw stand frame. Using the handles on the quick release mounting brackets, lift the miter saw and position the quick release mounting brackets onto the miter saw stand as shown in Figure 7 (SAW IS NOT SHOWN TO ALLOW VISIBILITY OF THE RAILS AND BRACKETS).

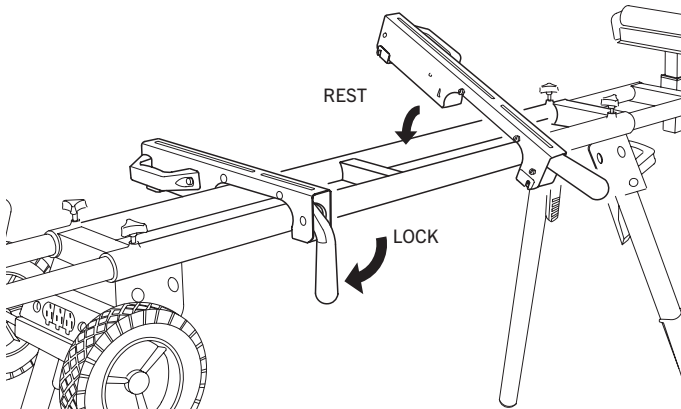

Figure 8

- Lower the saw into place and press the locking levers down to lock the mounting brackets into place.

WARNING

Do not use the miter saw stand for scaffolding or as a ladder. Make sure to securely tighten all fasteners before using. Maximum capacity is 330 lbs (150 kg). Power tools on the miter saw stand should not exceed a combined overall height of 60" (152.4 cm) from the floor.

OPERATION

ROLLERS BARS/EXTENSION BAR ADJUSTMENT

Refer to Figure 9

The extension bars move in and out to properly support the workpiece.

- Loosen the small locking knobs, slide the extension bar in or out to the required position, tighten the small locking knobs.

The roller bars are used as a directional rollers or with the extension bars as stationary stop guides.

- Loosen the large locking knobs, slide the roller bars up and down to desired location, tighten the large locking knobs.

MATERIAL SUPPORTS

Refer to Figure 9

Fold the material supports out to stack extra material for easy excess.

LEVELING

Refer to Figure 9

One leg is adjustable. Turn the leveling nut up or down to level the miter saw stand.

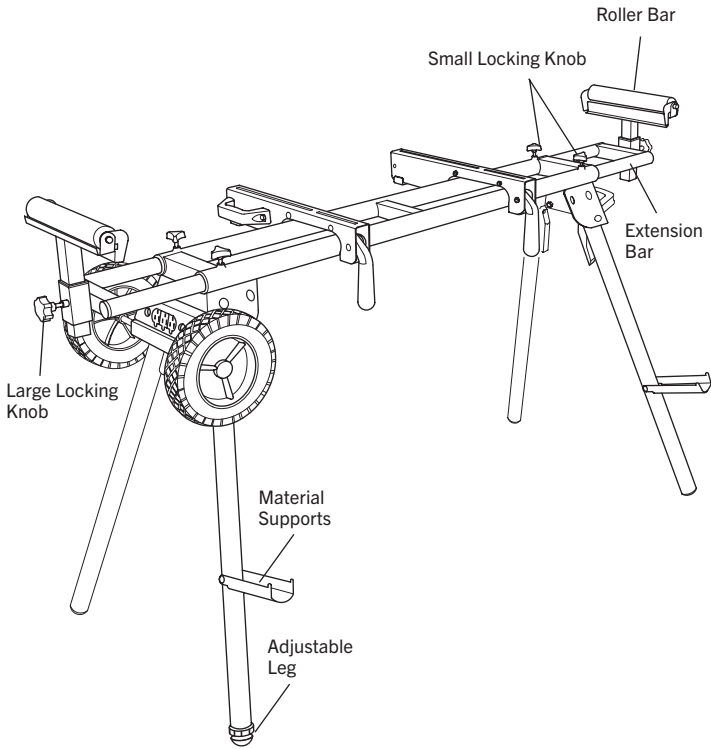

Figure 9

TRANSPORTATION

Refer to Figure 10

WARNING

Risk of unsafe operation. Ensure proper footing and use caution when rolling the miter saw stand to prevent tipping or loss of balance.

- Lift up on the end of the miter saw stand with wheels.
- While holding the stand with one hand, squeeze the release levers and fold up the two suspended legs. The legs will lock into place.
- Lower the stand until the wheels rest on a flat surface.
- Using the handle, tilt the other end of the miter saw stand up and transfer the weight to the wheels.
- Squeeze the release levers and fold up the remaining two legs. The legs will lock into place.
- Holding the handle, carefully lower the stand to the ground.
- To move the stand, use handle to lift and tilt the miter saw stand onto the wheels. Move miter saw stand as shown.

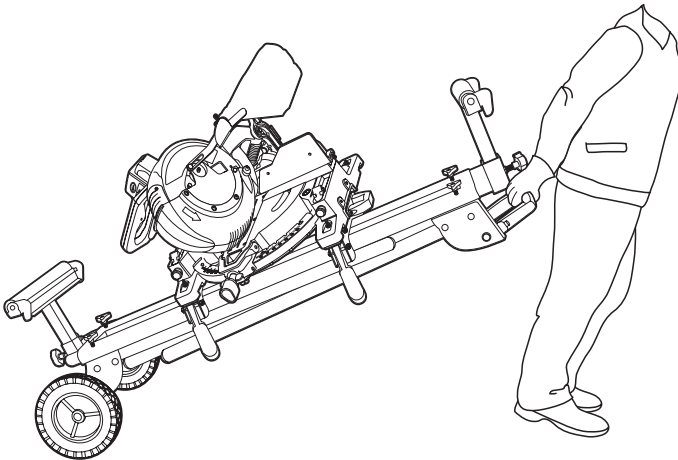

Figure 10

MAINTENANCE

GENERAL MAINTENANCE

WARNING

When servicing, use only identical replacement parts. Use of any other parts may create a hazard or cause product damage. To ensure safety and reliability, all repairs should be performed by a qualified service technician.

WARNING

Keep the miter saw stand dry, clean, and free from oil and grease. Always use a clean cloth when cleaning. Never use brake fluids, gasoline, petroleum based products or any strong solvent to clean the miter saw stand. Chemicals can damage, weaken or destroy plastic which may result in serious personal injury.

ADJUST QUICK RELEASE BRACKET

Refer to Figure 11

The quick release mounting brackets must be secure on the miter saw stand. If adjustment is needed:

Turn the adjusting nut on the adjustment screw clockwise to tighten the clamping tension.

Turn the adjusting nut on the adjustment screw counterclockwise to loosen the clamping tension.

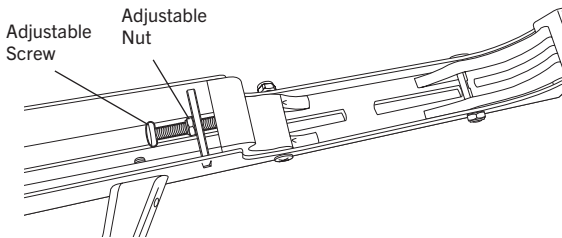
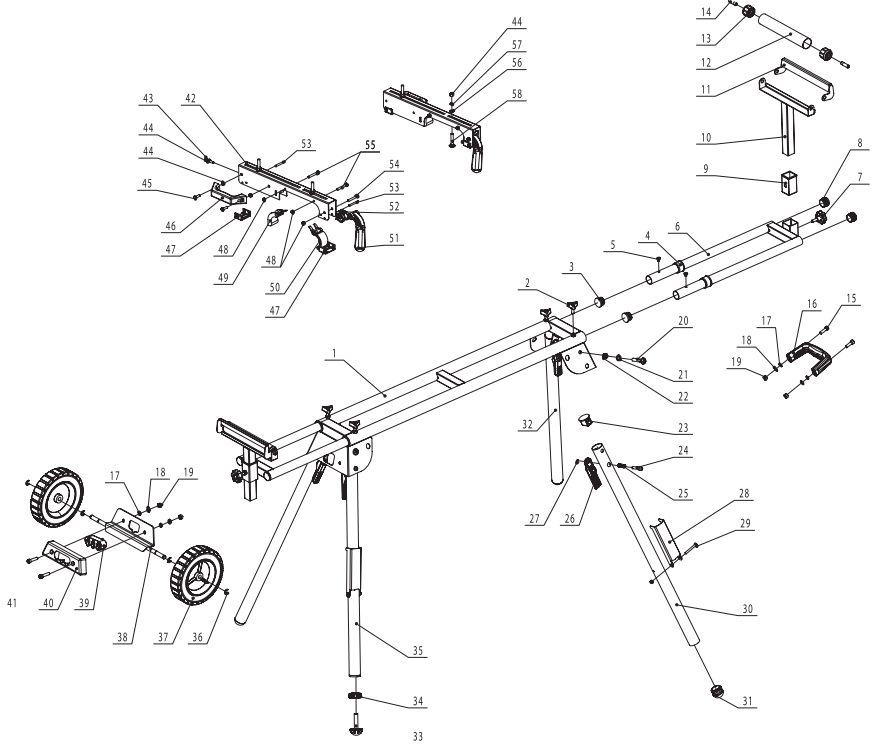

Figure 11

EXPLODED VIEW



PARTS LIST

KEY	PART	DESCRIPTION	SPECIFICATIONS	QTY
1	MS029I001	Frame welding		1
2	MS029I002	Star knob screw(small)		4
3	MS029I003	Internal endcaps	Φ 30	4
4	MS029I004	Insert endcaps		4
5	MS029I005	PH screw	6*8	4
6	MS029I006	Extension Rail		2
7	MS029I007	Star knob screw(big)		2
8	MS029I008	Internal endcaps	Φ 30	4
9	MS029I009	Star knob screw(big)		2
10	MS029I0010	Roller support bracket		2
11	MS029I0011	Support stop		2
12	MS029I0012	Roller	Φ 38*1.0*230	2
13	MS029I0013	Roller endcaps		4
14	MS029I0014	Slotted screw		4
15	MS029I0015	Bolt	M8*25	2
16	MS029I0016	Handle		1
17	MS029I0017	Split washer	Φ 8	4
18	MS029I0018	Flat washer	Φ 8*16*1.2	4
19	MS029I0019	Nut	M8	4
20	MS029I0020	FH shoulder screw	M10*55	4
21	MS029I0021	Flat washer	Φ 10	4
22	MS029I0022	Nylon fixing nut	m10	4
23	MS029I0023	Round tube endcaps	Φ 38	4
24	MS029I0024	Locking pin		4
25	MS029I0025	Spring	Φ 11*42.5	4
26	MS029I0026	Quick release leg lock lever		4
27	MS029I0027	C clip		4
28	MS029I0028	Material support		2
29	MS029I0029	Bolt	M6*50	2
30	MS029I0030	Leg	Φ 38*1.0*807	4
31	MS029I0031	Feet end cap		4
32	MS029I0032	Leg A	Φ 38*1.0*807	2
33	MS029I0033	Adjustable foot	PA	1
34	MS029I0034	Foot fixing part	ABS	1

KEY	PART	DESCRIPTION	SPECIFICATIONS	QTY
35	MS029I0035	Leg 1		1
36	MS029I0036	C clip		4
37	MS029I0037	Casters		2
38	MS029I0038	Axle plate		1
39	MS029I0039	Socket		1
40	MS029I0040	Socket fixing case	ABS	1
41	MS029I0041	Bolt	M8*35	2
42	MS029I0042	Saw mounting bracket		2
43	MS029I0043	Pan head screws	M6*35	2
44	MS029I0044	Nut	M6	10
45	MS029I0045	Hex Bolt	M6*20	4
46	MS029I0046	Saw mounting handle	PP	2
47	MS029I0047	Mounting bracket end cap	PE	4
48	MS029I0048	Nylon fixing nut	M6	6
49	MS029I0049	Rear clamp jaw		2
50	MS029I0050	Front clamp jaw	PA	2
51	MS029I0051	Mounting bracket handle	ABS	2
52	MS029I0052	Cam block	ABS	2
53	MS029I0053	Spring pin	5*45	4
54	MS029I0054	FH shoulder screw	7*45	2
55	MS029I0055	FH shoulder screw	6*45	4
56	MS029I0056	Flat washer	Φ 6	4
57	MS029I0057	Split washer	Φ 6	4
58	MS029I0058	Carriage Bolt	M6*60	4

WARRANTY

BENCHMARK MITER SAW STAND

If this Benchmark tool fail due to a defect in material or workmanship within two years from the date of purchase, return it to any Home Hardware store with the original bill of sale for exchange. This warranty does not include expendable parts including but not limited to blades, brushes, belts, light bulbs and/or batteries.

This warranty covers defects in material or workmanship only. It does not cover normal wear and tear, failure due to abuse/misuse, or defects caused by careless or accidental mishandling. If this Benchmark product is used for commercial or rental purposes, this warranty does not apply. For use at the consumer level. The warranty is not for industrial or commercial applications.

MITER SAW STAND

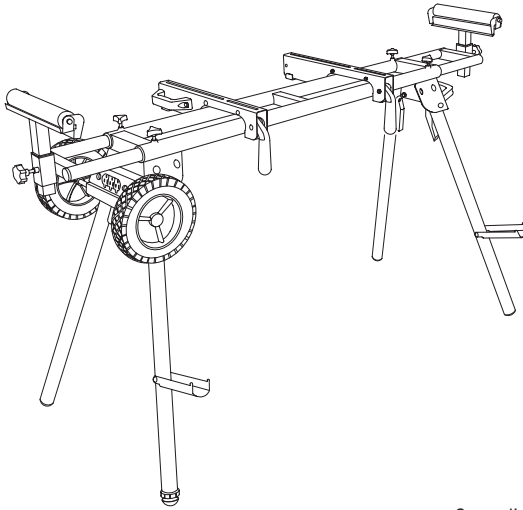

2 year limited warranty on tool

BENCHMARKTM_{MC}

BENCHMARK TOOLS CANADA
ST. JACOBS, ONTARIO N0B 2N0
© 2021 Home Hardware Stores Limited

CUSTOMER SERVICE/TECH SUPPORT
1-833-818-4111

1358-213

Made in China



* This BenchmarkTM product carries a two (2) year LIMITED warranty against defects in workmanship and materials. See Owner's Manual for full details.

**READ ALL INSTRUCTIONS BEFORE FIRST USE.
KEEP THIS MANUAL FOR FUTURE REFERENCE.
KEEP AWAY FROM CHILDREN.**



**WEAR CSA APPROVED
EYE PROTECTION**



**WEAR EAR
PROTECTION**



**WEAR A
FACE MASK**