

Radley®

Pneumatic Narrow Crown Stapler OWNER'S MANUAL



*3 Year
warranty*

3 Year Limited Warranty



**READ ALL INSTRUCTIONS BEFORE FIRST USE.
KEEP THIS MANUAL FOR FUTURE REFERENCE.
KEEP AWAY FROM CHILDREN.**



**WEAR CSA APPROVED
EYE PROTECTION**



**WEAR EAR
PROTECTION**



**WEAR FACE
PROTECTION**

PRODUCT SPECIFICATIONS

18 GAUGE 1/4" PNEUMATIC NARROW CROWN STAPLER	
Magazine Capacity	100
Fastener Capacity	18 Gauge 5/8" to 1- 1/2" Long
Staple	1/4" Narrow crown
Max PSI	120PSI
Average Air Consumption	0.9CFM @ 90PSI
Working pressure	70-110 PSI
Air inlet	1/4" NPT
Recommended hose	1/4" or 3/8"
Magazine angle	90°
Weight	3.1lb (1.5kg)

•Please note (where the 1/4" NPT connector is not already installed on the tool) your tool may be shipped with a black plastic cap installed in the air inlet. Pry the cap out prior to installing the 1/4" NPT connector.

NEED ASSISTANCE?

Call us on our toll-free customer support line:
1-866-349-8665 (Monday through Friday 9am – 5pm Eastern Standard Time)

- Technical questions
- Replacement parts
- Parts missing from package

 NOTE these instructions pertain to the tool only. Please refer to your compressors operator's manual and follow the manufactures instructions.

TABLE OF CONTENTS

Product Specifications 1
Table of Contents 2
Safety Guidelines 3-6
Symbols 7
Tool Specific Warnings 8
Know your 18Ga Pneumatic Narrow Crown Stapler 9
Assembly and Operating 10-14
Maintenance 15-17
Exploded View 18
Parts List 19-21
Warranty 22

SAFETY GUIDELINES

WARNING:

This manual contains information that relates to PROTECTING PERSONAL SAFETY and PREVENTING EQUIPMENT PROBLEMS. It is very important to read this manual carefully and understand it thoroughly before using the product. The symbols listed below are used to indicate this information.



DANGER!

Potential hazard that will result in serious injury or loss of life.



WARNING!

Potential hazard that could result in serious injury or loss of life.









CAUTION!

Potential hazard that may result in moderate injury or damage to equipment.

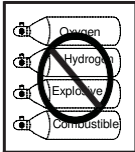
Note - The word " Note " is used to inform the reader of something he / she needs to know about the tool.

PERSONAL SAFETY

These precautions are intended for the personal safety of the user and others working with the user. Please take time to read and understand them.

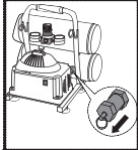
SYMBOL	MEANING
	<p>Do not use oxygen or any other combustible or bottled gas to power air-powered tools. Failure to observe this warning can cause explosion and serious personal injury or death.</p> <p>Use only the compressed air to power the air-powered tools. Use a minimum of 25' (7.6 m) of hose to connect the tool to the compressor. Failure to comply will result in serious injury or loss of life.</p> 
	<p>Risk of electric shock: Do not expose a compressor to rain. Store it indoors. Disconnect the compressor from power source before servicing. Compressor must be grounded. Do not use grounding adaptors.</p>
	<p>Risk of personal injury: Do not direct compressed air from the air hose towards the user or other personnel.</p>
	<p>Risk of inhalation: Never directly inhale the air produced by the compressor.</p>
	<p>Risk of bursting: Do not adjust the pressure switch or safety valve for any reason. They have been preset at the factory for this compressor's maximum pressure. Tampering with the pressure switch or the safety valve may cause personal injury or property damage.</p>
	<p>Risk of burns. The pump and the manifold generate high temperatures. In order to avoid burns or other injuries, do not touch the pump, the manifold, or the transfer tube while the compressor is running. Allow the parts to cool down before handling or servicing. Keep children away from the compressor at all times.</p>
	<p>Risk of bursting: Make sure the regulator is adjusted so that the compressor outlet pressure is set lower than the maximum operating pressure of the tool. Before starting the compressor, pull the ring on the safety valve to make sure the valve moves freely. Drain water from tank after each use. Do not weld or repair tank. Relieve all pressure in the hose before removing or attaching accessories.</p> 

DANGER!



- Keep children away from the work area. Do not allow children to handle power tools.
- Do not use this tool in the presence of flammable liquids or gases. Sparks that are created during use may ignite gases.
- Keep air hose away from heat, oil, and sharp edges. Check air hose for wear before each use and ensure that all connections are proper.
- Always ensure that the workpiece is firmly secured leaving both hands free to control the tool.
- Always ensure that the tool has stopped before putting it down after use, for safety purposes and to prevent possible damage to the tool/user.
- Keep proper footing at all times in order to ensure correct balance.
- Always assume that the tool contains fasteners.
- Do not point the tool toward yourself or anyone else.

WARNING!



- **Do not allow unskilled or untrained individuals to operate** the tool.
- **Do not use the tool for any task other than that it is designed to perform.**
- **Locate the compressor in a well-ventilated area** for cooling, and a minimum of 12" (31 cm) away from the nearest wall.
- **Protect the air hose and the power cord from damage and puncture. Inspect them for weak or worn spots every week** and replace them if necessary.
- **Always wear hearing protection** when using the air compressor. Failure to do so may result in hearing loss.
- **Do not carry the compressor while it is running.**
- **Do not operate the compressor if it is not in a stable position.**
- **Do not operate the compressor on a rooftop or an elevated position** that could allow the unit to fall or be tipped over
- **Always replace a damaged gauge** before operating the unit again.
- Do not connect the tool to a compressed air source with a pressure output that is higher than 120PSI

CAUTION!



- Always ensure that the tool has stopped before connecting to the air supply.
- Do not wear watches, rings, bracelets, or loose clothing when using any air-powered tool.
- Do not overload the tool. Allow the tool to operate at its optimum speed for maximum efficiency.
- Do not use a tool that is leaking air, that has missing or damaged parts, or that requires repairs. Verify that all screws are securely tightened.
- For optimal safety and tool performance, inspect the tool daily in order to ensure free movement of the trigger, safety mechanisms, and springs.
- Always keep your air tool clean and lubricated. Daily lubrication is essential to avoid internal corrosion and possible failures.
- Ensure the floor is not slippery and wear non-slip shoes. Floors should be kept clean and clear.
- Always follow all workshop safety rules, regulations, and conditions when using the tool.
- Carry the tool by the handle only, keeping fingers away from the trigger. Do not carry the tool by the hose, magazine, or any other parts.
- Do not use the tool near or below freezing point, as doing so may cause tool failure.
- Do not store the tool in a freezing environment to prevent ice formation on the tools operating valves, as doing so may cause tool failure.
- Handling and storage of oil: Use with adequate ventilation. Avoid contact of oil with eyes, skin, and clothing. Avoid breathing spray or mist. Store in a tightly closed container in a cool, dry, well-ventilated area free from incompatible substances.
- Tripping hazard. The air hose may become a tripping hazard when it is placed in the work area. Use care when walking in the work area.

**CAUTION!**

- **Disconnect tool from the air supply and turn off the compressor** before performing any maintenance or changing accessories, when clearing a jammed fastener, when the tool is not in use, when it is being handed to another person, and when it is left unattended. Failure to comply may result in moderate injury or damage to equipment.

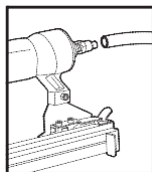

- **Use safety goggles and ear protection:** Wear safety glasses with side shields when operating the tool/compressor and verify that others in the work area are also wearing safety glasses. Safety glasses must conform to American National Standards Institute (ANSI Z87.1) requirements and must provide protection from flying particles from the front and the sides. Air-powered tools are loud, and the sound can cause hearing damage. Always wear ear protection to prevent hearing damage and loss. Failure to comply may result in moderate injury.



Note: Recycle unwanted materials rather than disposing of them as waste. Sort the tools, hoses, and packaging in specific categories and take to the local recycling center or dispose of in an environmentally safe way.

SYMBOLS

! WARNING: Some of the following symbols may appear on the tool. Study these symbols and learn their meaning. Proper interpretation of these symbols will allow for more efficient and safer operation of this tool.

SYMBOLS

Read operator's manual: To reduce the risk of injury, user must read and understand operator's manual before using this product.



Risk to hearing: Always wear ear protection when using this tool. Failure to do so may result in hearing loss.



Eye protection: Always wear safety goggles, safety glasses with side shields, or a full-face shield when operating this product.

TOOL SPECIFIC WARNINGS

- Risk of serious personal injury: Never place hand or other body parts in fastener discharge area, the tool might eject a fastener and could result in death or serious personal injury.
- Remove finger from trigger when not driving fasteners.
- Never carry tool with finger on trigger. Accidental discharge could result.
- Use the tool only for its intended use. Do not discharge fasteners into open air, concrete, stone, extremely hard woods, knots, or any material too hard for the fastener to penetrate.
- Always keep fingers clear of contact tip (nose of tool) to prevent injury from inadvertent release of staples.
- Do not point to tool at yourself or anyone else.
- Use only the recommended fasteners with this tool.
- Do not drive staples blindly into walls, floors, or other work areas. Fasteners driven into live electrical wires, plumbing or other types of obstructions can result in injury.

Know Your Pneumatic Narrow Crown Stapler

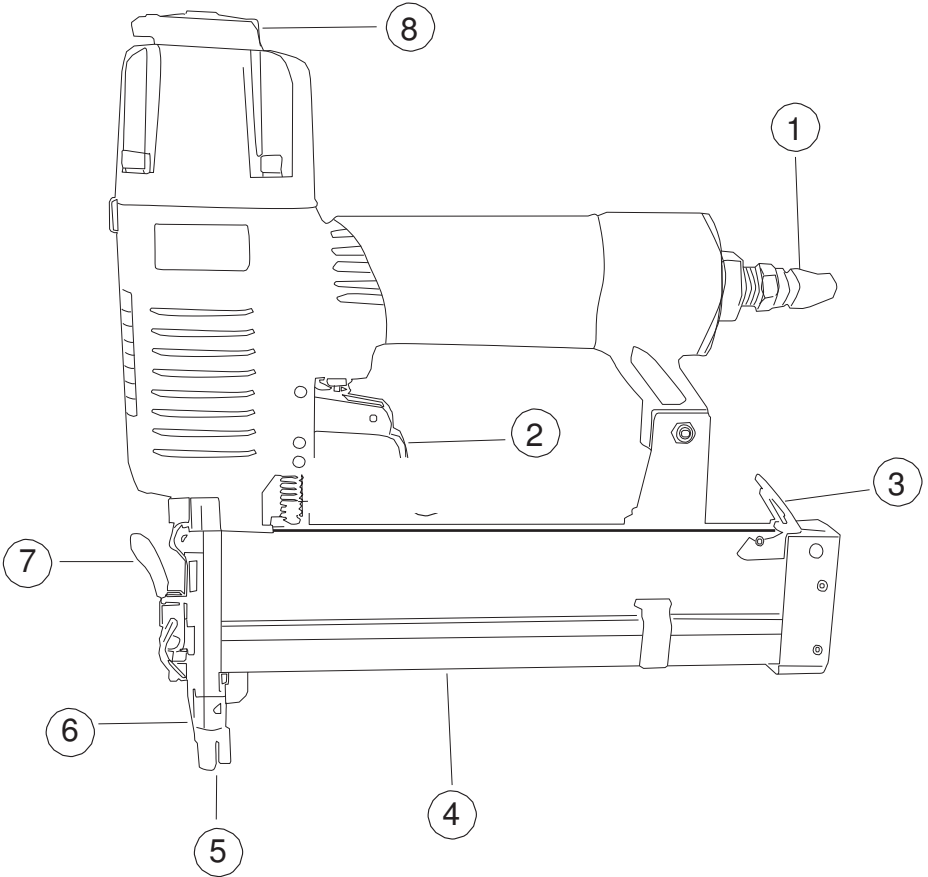

No.	Description	No.	Description
1	Air inlet plug	6	Safety stand
2	Trigger	7	Quick staple extraction lever
3	Magazine latch	8	Air deflector
4	Magazine		
5	Workpiece contact		

ASSEMBLY AND OPERATING

The 18 Gauge 1/4" NarrowCrown Pneumatic Stapler is ideal for all general-purpose wood fastening. The lightweight, narrow body tool is easy to handle, making it ideal for installing trim in tight areas. The air stapler has 100 staple magazine with an easy-clear front nose hatch. Drives 18-gauge 1/4" narrowcrown staples from 5/8" to 1-1/2" long.

COMPATIBLE COMPRESSORS

GUIDELINES FOR PROPER USE AND OPERATION

Be sure to use a proper air compressor with air-powered tools. The compressor should be able to supply a minimal air delivery of 0.9 CFM @ 90 PSI to ensure the compressor can run continuously with the tool.

Air Compressor Size and Power	1/3–1 1/3 HP	1 1/2 HP	2+ HP
2–6 Gallons	Light-duty and Intermittent use	Light-duty and Intermittent use	Light-duty and Intermittent use
8-11 Gallons	Light-duty and Intermittent use	Medium-duty and Intermittent use	Medium-duty and Intermittent use
15+ Gallons	Medium-duty and Intermittent use	Heavy-duty and Continuous use	Heavy-duty and Continuous use

Wood Density	Staple Size	Compressor Air Pressure
> 0.6g/cm ³	<19 mm staples	90 PSI (6.3 bar)
	≥19 mm staples	100 PSI (7 bar)
≤ 0.6g/cm ³	<19 mm staples	70 PSI (4.8 bar)
	≥19 mm staples	90 PSI (6.3 bar)

AIR SYSTEM

Always use clean, dry, regulated, compressed air at 4.8 to 7.5 bar (70 to 110 PSI). Do not exceed the maximum or minimum pressures. Operating the tool at the wrong pressure (too low or too high) will cause excessive noise or rapid wear of tool.

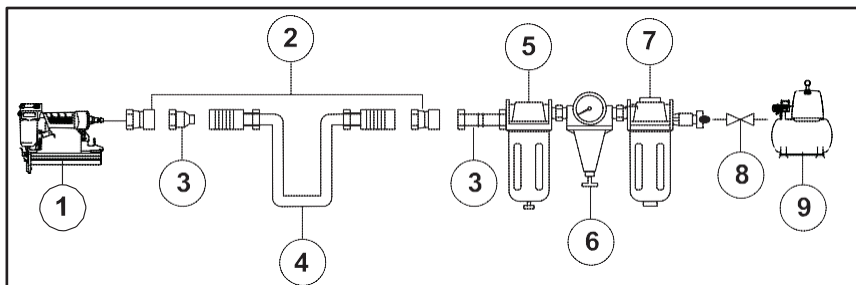

No.	Description	No.	Description
1	18Ga Narrow Crown	6	Regulator (0 to 7.5 bar)
2	Quick connector	7	Filter
3	Quick coupler	8	Cut-off valve
4	Air hose	9	Air compressor
5	Lubricator		

⚠ WARNING The use of any other types of fasteners will cause the tool to jam. Failure to comply could lead to serious injury or loss of life.

It is recommended that a filter-regulator-lubricator is used and located as close to the tool as possible.

If a filter-regulator-lubricator is not installed, place 2 to 3 drops of compressor oil into the NPT inlet plug before each use.

If a filter-regulator-lubricator is installed, keep the air filter clean. A dirty filter will reduce the air pressure to the tool, which will cause reduction in power, efficiency, and general performance.

For optimal performance, install a quick coupler in the hose, if applicable.

Verify that all of the connections in the air supply system are sealed in order to prevent air from leaking.

Verify that all of the connections in the air supply system are sealed in order to prevent air from leaking. Failure to comply may result in moderate injury or damage to equipment.

Air tools

Read this Instruction Manual carefully before using the tool

Read and follow all the safety instructions at the beginning of this manual. Inspect the air-powered tool prior to each use in order to:

- Ensure that the proper power source is being used.
- Verify that the tool is in proper working order.
- Verify that the air pressure level (s) are properly set on the air compressor.

Do not use the tool if it is not in proper working order.

Do not use oxygen, CO₂ (carbon dioxide) or any other combustible, or bottled gas to power this tool.

Do not use this tool in the presence of any flammable liquids or gases.

Keep hands and other parts of the body away from the firing head during use.

Do not point the tool towards the operator or other people.

Never attempt to clear a jammed fastener while the air hose is connected.

Do not drive a fastener on top of an existing fastener. Failure to comply could lead to serious injury or loss of life.

This 18Ga Narrow Crown Stapler drives 18-gauge 15.9 to 38 mm (5/8 to 1-1/2") staples.

ACCEPTABLE STAPLES

Length: 5/8–1-1/2" (15.9 to 38 mm)

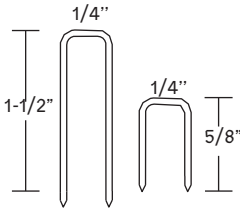

Loading staples



DANGER!

- Disconnect the tool from the compressed air source before loading staples.
- Do not point the tool towards the operator or other people while changing staples.
- Do not hold the tool with the trigger pressed while changing the staples. Failure to comply will lead to serious injury or loss of life.

1. Disconnect the tool (1) from the air hose (2).

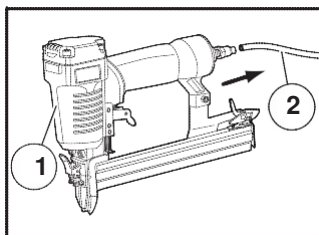

2. Take hold of the stapler firmly with one hand and use the other hand to press the latch (1) on the magazine (2) and slide it back to open. Insert a strip of staples into the magazine. Ensure the points of the staples are facing down.

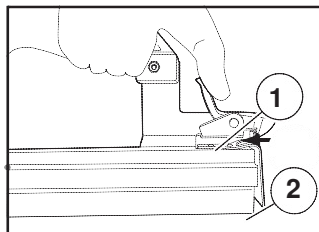

3. Push the staples back into the magazine and close the magazine (1) until "clicks" into place.

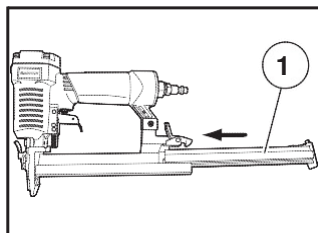

4. Plug in compressor, turn it on, set the pressure regulator to 90 psi, attach one end of the air hose to the compressor and the other end of the air hose (1) to the tool (2).

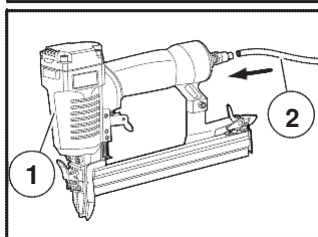

WARNING!

- The safety tip must be in contact with the workpiece before activating the tool.
- Do not operate the tool if the staples are not loaded, as doing so may damage the tool.
- Do not fire staples into the air, as doing so may cause injury to the operators or others, apart from damaging the tool.
- Load the correct type of staples only. Failure to comply could lead to serious injury or loss of life.
- Disconnect the tool from the air supply line.

Firing mode

Single-Sequential Actuation

To operate the tool, first position the Workpiece Contact (nose of tool) on the work surface, **WITHOUT PULLING THE TRIGGER**. Depress the Workpiece Contact until the Workpiece contact (nose of tool) touches the work surface and then pull the trigger to drive a fastener. Do not press the tool against the work with extra force. Instead allow the tool to recoil off the work surface to avoid a second, unwanted fastener. Remove your finger from the trigger and repeat.

INCREASING AND DECREASING FASTENER DEPTH

Test the driving depth of the tool against a sample piece of wood by pressing the trigger before working on the workpiece.

If the staples are being driven too deep or not deep enough, adjust the regulate in order to provide more or less air pressure as required.



WARNING: Ensure the discharge end of tool is pointed away from the operator while adjusting depth).

Clearing a jammed Staple



WARNING: Disconnect the tool from the air supply line before attempting to clear a jammed staple.

To clear a jammed Staple

- Remove the staples that are stored in the tool's magazine.
- Operate the latch and pull it back to open the magazine. Use pliers or any appropriate tool to remove the jammed staples.
- If the staple is jammed in the "firing" location, pull the Quick Staple Extraction lever away from the tool to access and remove the jammed staple.
- Reload the staples into the tool magazine.
- Slide the pusher against the staples to close the magazine and verify that the latch is moved to its original position.
- Reconnect the airline to the tool's air inlet.
- Test fire 3 to 5 staples into a piece of scrap wood in order to ensure proper operation.

Storage

- If it is necessary to store the tool for an extended period of time, apply a generous amount of lubrication before storing.
- The tool should be allowed to run for approximately 30 seconds after lubricating, in order to ensure that the lubrication is uniformly distributed throughout the tool.

Maintenance

NOTE: Do not store the tool anywhere temperatures will fall below freezing.



DANGER!

Disconnect the tool from the air compressor before maintenance, adjusting, cleaning jams, reloading, and when it is not in use. Repairs must be performed by a qualified service technician only. Failure to comply will lead to serious injury or loss of life.

MAINTENANCE REQUIRED	DESCRIPTION	TOOLS OR MATERIALS REQUIRED	MAXIMUM SERVICE INTERVAL		
			Each use or every 2 hrs.	Monthly	As needed
General inspection - free movement	Trigger, spring,	None	X		
In-depth inspection	Worn or broken parts			X	X
Replace worn or broken parts					X
Lubrication	See below	Pneumatic tool oil	X		

- Lubrication: If the tool and the compressor are not equipped with an in-line lubrication system, place up to 6 drops of pneumatic tool oil into the air inlet before each use or after every 2 hours of continuous use, depending on the characteristics of the workpiece and type of staples used.

Troubleshooting



DANGER!

If any of the following symptoms appear while the tool is in use, turn it off and disconnect it from the air supply immediately. Failure to comply will lead to serious injury or loss of life. Disconnect the tool from the air supply before making any adjustments. Repairs must be performed by a qualified service technician only. The following chart lists common issues and solutions. Please read it carefully and follow all instructions carefully.

Problem	Possible causes	Solutions
Air leakage at the top of the tool or in the trigger area.	<ol style="list-style-type: none"> 1. O-rings in the trigger valve are damaged. 2. The trigger valve heads are damaged. 3. Trigger valve stem, seal, or O-rings are damaged. 	<ol style="list-style-type: none"> 1. Inspect and replace the O-ring. 2. Inspect and replace trigger valve heads. 3. Inspect and replace the trigger valve stem, seal, or O-ring
Air leakage near the bottom of the tool.	<ol style="list-style-type: none"> 1. The screws are loose. 2. The O-rings or the bumper are worn or damaged. 	<ol style="list-style-type: none"> 1. Tighten the screws. 2. Inspect and replace the O-rings or the bumper.
Air leakage between the bottom and the cylinder cap.	<ol style="list-style-type: none"> 1. The screws are loose. 2. The O-rings or the seals are worn or damaged. 	<ol style="list-style-type: none"> 1. Tighten the screws. 2. Inspect and replace the O-rings or the seals.

Problem	Possible causes	Solutions
The staples are being driven too deep.	<ol style="list-style-type: none"> 1. The bumper is worn. 2. The air pressure is too high. 	<ol style="list-style-type: none"> 1. Replace the bumper. 2. Adjust the air pressure.
The tool does not operate properly - it does not drive the staples or operates sluggishly.	<ol style="list-style-type: none"> 1. The air supply is inadequate. 2. Lubrication is inadequate. 3. The O-rings or seals are worn or damaged. 4. The exhaust deflector in the cylinder head is blocked. 	<ol style="list-style-type: none"> 1. Verify that the air supply is adequate. 2. Pour up to 6 drops of oil into the air inlet. 3. Inspect and replace O-rings or seals. 4. Replace the damaged internal parts.
The tool skips staples.	<ol style="list-style-type: none"> 1. The bumper is worn, or the spring is damaged. 2. There is dirt in the front plate. 3. The O-ring on the piston is worn or dry or lubrication is insufficient. 4. The cylinder cover seal is leaking. 	<ol style="list-style-type: none"> 1. Replace the bumper or spring. 2. Clean the drive channel on the front plate. 3. Clean the magazine. 4. Replace the O-ring. 5. Replace the sealing washer.
The tool jams.	<ol style="list-style-type: none"> 1. Improper staples are used, or staples are damaged. 2. The driver guide is damaged or worn. 3. The magazine screw is loose. 4. There is dirt in magazine. 	<ol style="list-style-type: none"> 1. Use proper staples. (See section "Clearing a jammed staples.") 2. Inspect and replace the driver. 3. Tighten the magazine. 4. Open and clean the magazine.
Air exhaust is being directed towards the operator.	The direction of the exhaust port requires adjustment.	Direct the exhaust port away from the operator.

EXPLODED VIEW

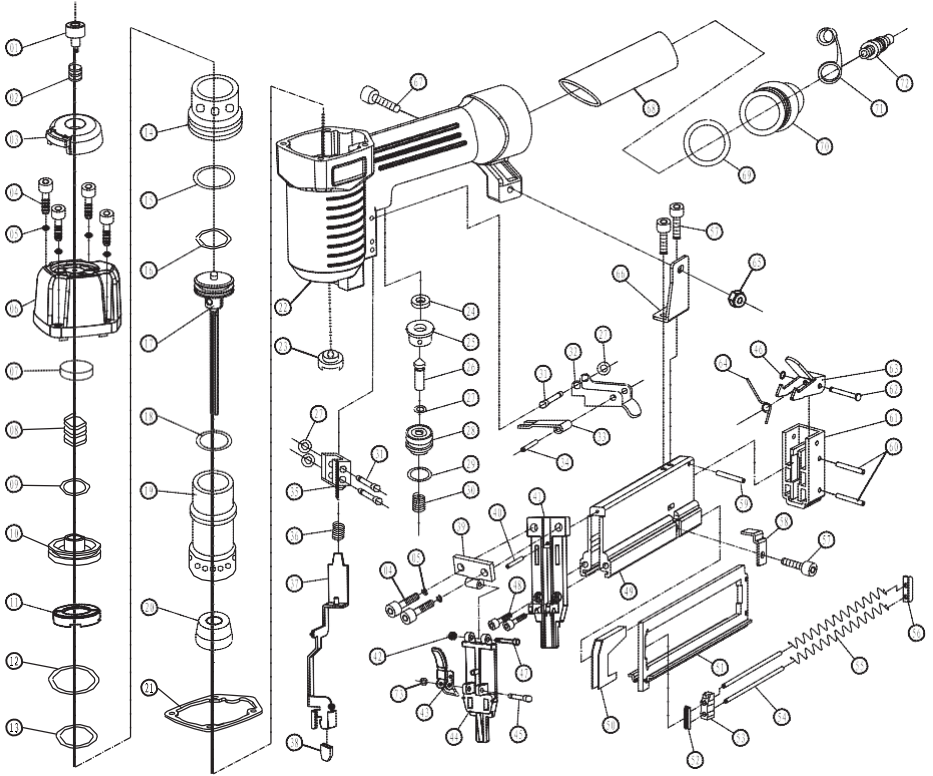

PARTS LIST

⚠ WARNING When servicing, use only original equipment replacement parts. The use of any other parts may create a safety hazard or cause damage to the tool. Any attempt to repair or replace electrical parts on this tool may create a safety hazard unless repairs are performed by a qualified technician. For more information, call the Toll-free Helpline, at 1-866-349-8665.

Always order by PART NUMBER, not by key number.

Key#	Part #	Part Name	Qty
1	1282-405-001	Bolt	1
2	1282-405-002	Spring	1
3	1282-405-003	Air deflector	1
4	1282-405-004	Bolt M5×5	6
5	1282-405-005	O-ring	6
6	1282-405-006	Cylinder cover	1
7	1282-405-007	Sealing washer	1
8	1282-405-008	Compressed spring	1
9	1282-405-009	O-ring 13.7×2.4	1
10	1282-405-010	Head valve	1
11	1282-405-011	Washer	1
12	1282-405-012	O-ring 31.2×2.5	1
13	1282-405-013	O-ring 24.8×3.5	1
14	1282-405-014	Collar	1
15	1282-405-015	O-ring 42.5×2.5	1
16	1282-405-016	O-ring 21×3	1
17	1282-405-017	Main piston	1
18	1282-405-018	O-ring 30×1.8	1
19	1282-405-019	Cylinder	1
20	1282-405-020	Bumper	1
21	1282-405-021	Sealing washer	1
22	1282-405-022	Gun body	1
23	1282-405-023	Rubber washer	1
24	1282-405-024	Rectangle Washer 12.9×7×1.8	1
25	1282-405-025	Trigger Valve Seat	1
26	1282-405-026	Trigger Valve Stem	1
27	1282-405-027	O-ring 1.7×2	4
28	1282-405-028	Trigger Valve Guide	1
29	1282-405-029	O-ring 11.2×2	1
30	1282-405-030	Spring	1

Key#	Part #	Part Name	Qty
31	1282-405-031	Pin	3
32	1282-405-032	Trigger	1
33	1282-405-033	Safety spacer	1
34	1282-405-034	Pin 2.5×1.6	1
35	1282-405-035	WCE guide	1
36	1282-405-036	Pusher spring	1
37	1282-405-037	Safety stand	1
38	1282-405-038	Nose head	1
39	1282-405-039	Spacer	1
40	1282-405-040	Pin 2×10	1
41	1282-405-041	Driver guide	1
42	1282-405-042	Bushing	1
43	1282-405-043	Quick release handle	1
44	1282-405-044	Driver Guide Cover	1
45	1282-405-045	Pin	1
46	1282-405-046	Snap washer	1
47	1282-405-047	Pin	1
48	1282-405-048	Bolt M4×15	2
49	1282-405-049	Fixed magazine	1
50	1282-405-050	Pusher	1
51	1282-405-051	Movable magazine	1
52	1282-405-052	Fixed block I	1
53	1282-405-053	Pusher block	1
54	1282-405-054	Pusher pipe	2
55	1282-405-055	Spring	2
56	1282-405-056	Fixed block II	1
57	1282-405-057	Bolt M4×7	3
58	1282-405-058	Bale	1
59	1282-405-059	Pin 3×18	1
60	1282-405-060	Pin 3×22	2
61	1282-405-061	Fixed seat	1
62	1282-405-062	Pin	1
63	1282-405-063	Latch	1
64	1282-405-064	Spring	1
65	1282-405-065	Nut M4	1
66	1282-405-066	Support seat	1

Key#	Part #	Part Name	Qty
67	1282-405-067	Bolt M4×14	1
68	1282-405-068	Rubber handle	1
69	1282-405-069	O-ring 36.3×3.55	1
70	1282-405-070	End cap	1
71	1282-405-071	Air plug case	1
72	1282-405-072	Air inlet plug	1

WARRANTY

RADLEY WARRANTY

If this Radley tool fails due to a defect in material or workmanship within three years from the date of purchase, return it to any Home Hardware store with the original bill of sale for exchange. Two years for battery and charger. This warranty does not include expendable parts including but not limited to blades, brushes, belts, and light bulbs. This warranty covers defects in material or workmanship only. It does not cover normal wear and tear, failure due to abuse/misuse, or defects caused by careless or accidental mishandling. If this Radley product is used for commercial or rental purposes, this warranty does not apply.

Radley®

18 Gauge 1/4" Narrow Crown Pneumatic Stapler OWNER'S MANUAL



3 Year Limited Warranty on tool

Radley®

RADLEY TOOLS
ST. JACOBS, ONTARIO N0B 2N0
© 2021 Home Hardware Stores Limited
1-866-349-8665
Customer Service/Tech Support

1282-405

Made in China

**3 Year
warranty**

This Radley® product carries a three (3) year LIMITED warranty against defects in workmanship and materials. See Owner's Manual for full details.

**READ ALL INSTRUCTIONS BEFORE FIRST USE.
KEEP THIS MANUAL FOR FUTURE REFERENCE.
KEEP AWAY FROM CHILDREN.**



**WEAR CSA APPROVED
EYE PROTECTION**



**WEAR EAR
PROTECTION**



**WEAR FACE
PROTECTION**