

# WINEGARD®

## Model TR-2000 Tripod/Base Mount

**CAUTION: Winegard Company does not warrant this product if a mount pipe longer than 18" is used.  
NOT DESIGNED FOR USE WITH RD-9046 OR PM-2000 PORTABLE SATELLITE SYSTEMS.**

STEP 1: FOR FIRST TIME USE. To attach adjustment knob using 5/16-18 square nut and nut clamp, put pole into base. Turn upside down. Place nut inside nut clamp, and drop into slot on bottom of base, making sure the open side of the nut clamp is toward the flat side of the base, Figure 1 and 1A. Screw in adjustment knob. For travel/storage, remove pipe.

STEP 2: To store compass when not in use, attach compass to base using velcro provided, Figure 2.

STEP 3: Secure level to base using double-sided tape (provided), Figure 2.

STEP 4: Insert spring clips into the support legs until locked in place, Figure 2.

STEP 5: Slide legs into base until locked in place.

STEP 6: After tripod is assembled, go to Operation, page 2.

**Figure 1**

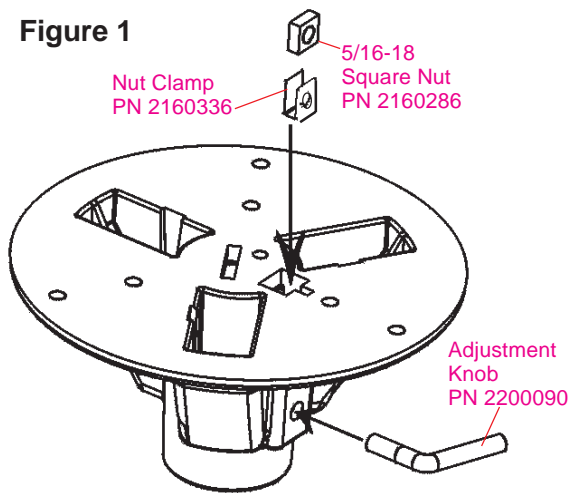

**Figure 1A**

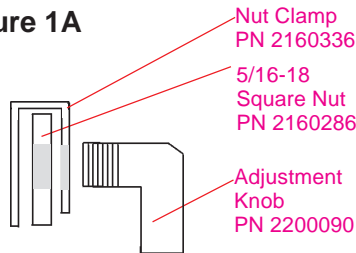

**Nut and Clamp detail**



**Figure 2**

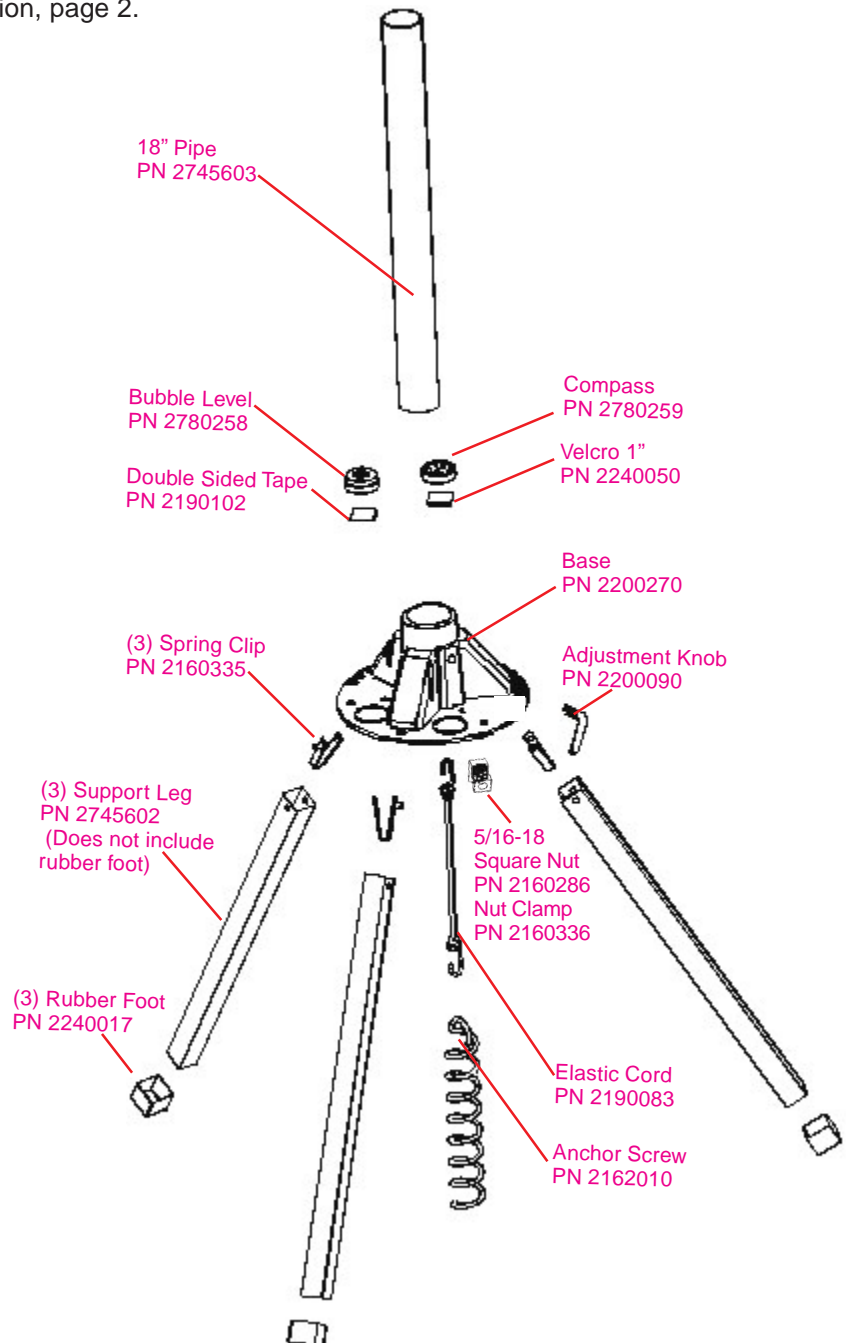

## TRIPOD MOUNT OPERATION

**STEP 1.** Turn your receiver on, and using the installation menus, determine the heading (azimuth) and elevation for your location.

**STEP 2. Remove the compass from the mount.** (The metal pipe and antenna **WILL** effect compass operation.) Using the compass, determine the best location for the mount. The satellite signal **WILL NOT** go through trees, buildings, etc.

**STEP 3.** After determining the best location, screw the anchor into the ground. A large screwdriver or piece of pipe through the top loop of the anchor makes this easier.

**STEP 4.** Attach the elastic cord to the bottom of the mount base, Figure 3.

**STEP 5.** Set mount over the anchor screw and attach elastic cord to the anchor, Figure 4.

**STEP 6.** If the compass was removed earlier, reattach it to the mount base. Rotate the mount so the arrow on the mount points north.

**STEP 7.** Adjust the mount legs until bubble level shows mount is level.

**STEP 8.** Attach mount pipe to the antenna and tighten. Adjust antenna elevation to the correct setting for your location.

**STEP 9.** Set the antenna/pipe onto the mount. Connect antenna to receiver.

**STEP 10.** Using the heading (azimuth) markings on mount base, **SLOWLY** rotate antenna to the correct heading. If you do not find the satellite, be sure you have entered the correct zip code for your location, and that there are no obstructions (trees, buildings, hills, etc.).

**STEP 11.** After you have found the satellite, secure the pipe using the adjustment knob.

Figure 4

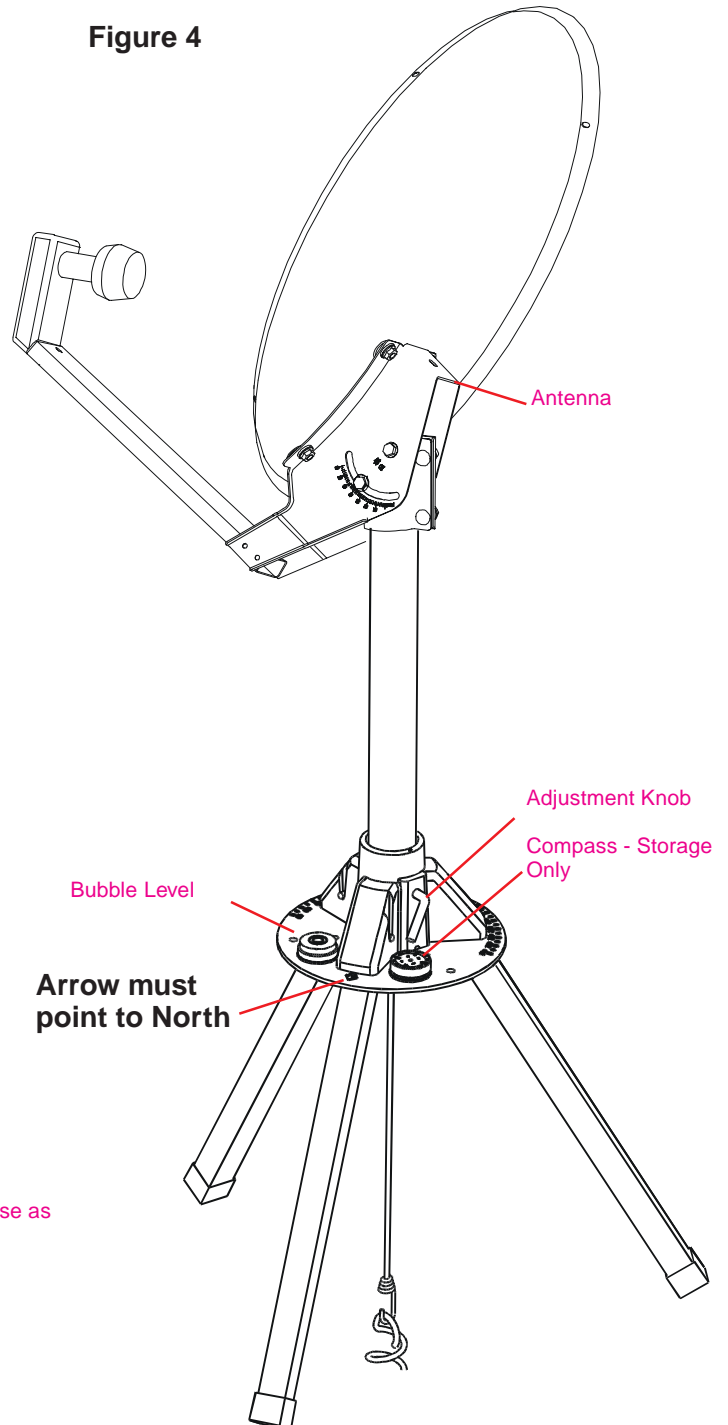
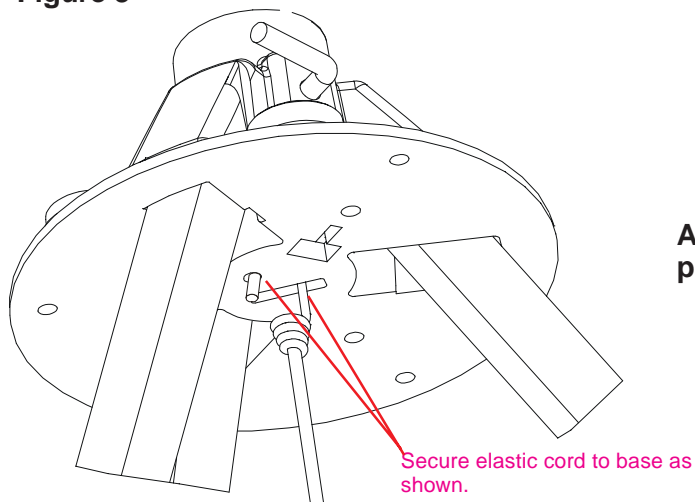

Figure 3



## BASE MOUNT OPERATION

**STEP 1.** Turn your receiver on, and using the installation menus, determine the heading (azimuth) and elevation for your location.

**STEP 2. Remove the compass from the mount.** (The metal pipe and antenna **WILL** effect compass operation.) Using the compass, determine the best location for the mount. The satellite signal **WILL NOT** go through trees, buildings, etc.

**STEP 3.** After you have determined the best location, secure mount to deck using 1/4" diameter lag screws or bolts (not supplied). Mount must be level and the arrow on the mount must point north, Figure 5.

**STEP 4.** Attach mount pipe to the antenna and tighten. Adjust antenna elevation to the correct setting for your location.

**STEP 5.** Set the antenna/pipe onto the mount. Connect antenna to receiver.

**STEP 6.** Using the heading (azimuth) markings on mount base, **SLOWLY** rotate antenna to the correct heading. If you do not find the satellite, be sure you have entered the correct zip code for your location and that there are no obstructions (trees, buildings, hills, etc.).

**STEP 7.** After you have found the satellite, secure the pipe using the adjustment knob.

Figure 5

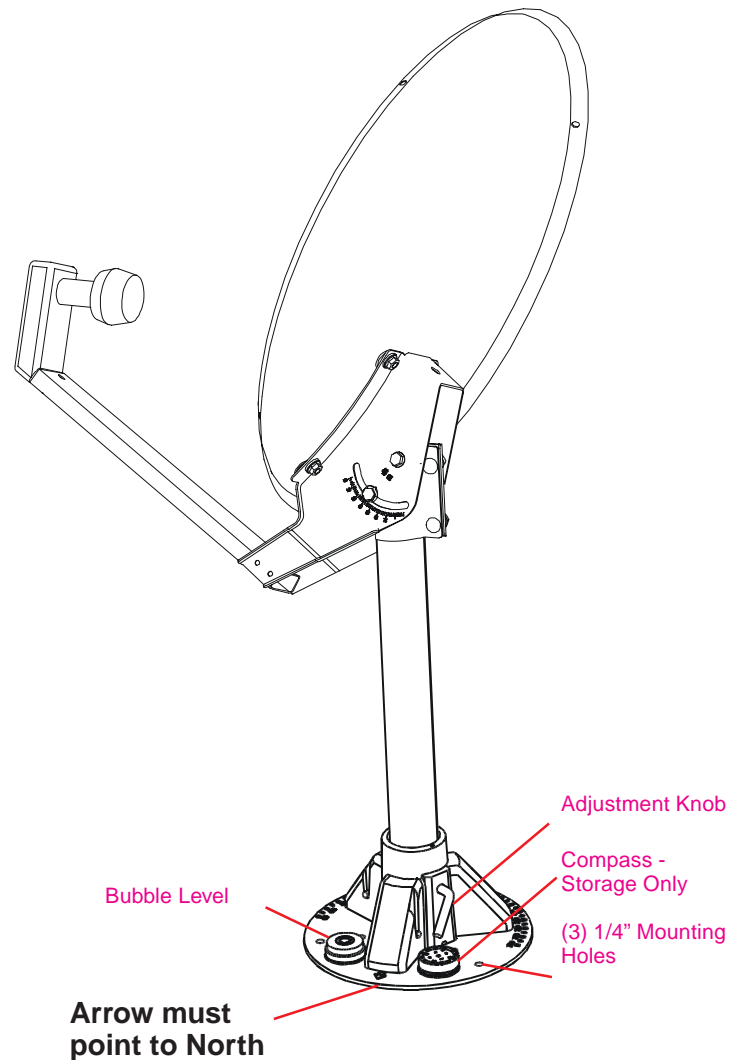

## **MOBILE PRODUCTS & LNBF - TWO YEAR LIMITED WARRANTY**

Winegard Company warrants this Winegard product against any defects in materials or workmanship within two (2) years from date of purchase. No warranty claim will be honored unless at the time the claim is made, you present proof of purchase to an authorized Winegard dealer (if unknown, please contact Winegard Company, 3000 Kirkwood Street, Burlington, IA 52601-2000, Telephone 319-754-0600).

Winegard Company (at its option) will either repair or replace the defective product at no charge to you. This warranty covers parts, but does not cover any costs incurred in removal, shipping or reinstallation of the product. This limited warranty does not apply if the product is damaged, deteriorates, malfunctions or fails from: misuse, improper installation, abuse, neglect, accident, tampering, modification of the product as originally manufactured by Winegard, usage not in accordance with product instructions or acts of nature such as damage caused by wind, lightning, ice or corrosive environments such as salt spray and acid rain.

The Two (2) Year Warranty is provided on the condition that the equipment is properly delivered with all handling and freight charges prepaid to your Winegard dealer for return to our factory for repair or replacement. Winegard dealers will arrange for the replacement or repair and return to you without charge the product which failed due to defective material or workmanship.

WINEGARD COMPANY WILL NOT ASSUME ANY LIABILITIES FOR ANY OTHER WARRANTIES, EXPRESS OR IMPLIED, MADE BY ANY OTHER PERSON.

ALL OTHER WARRANTIES WHETHER EXPRESS, IMPLIED OR STATUTORY INCLUDING WARRANTIES OF FITNESS FOR A PARTICULAR PURPOSE AND MERCHANTABILITY ARE LIMITED TO THE TWO YEAR PERIOD OF THIS WARRANTY.

The foregoing shall be the sole and exclusive remedy of any person, whether in contract, tort or otherwise, and Winegard shall not be liable for incidental or consequential damage or commercial loss, or from any other loss or damage except as set forth above.

Some states do not allow limitations on how long an implied warranty lasts, or the exclusion of limitation of incidental or consequential damages, so the above limitations or exclusions may not apply to you.

This warranty gives you specific legal rights and you may also have other rights which vary from state to state.